

Drunkard's Path + Scraps



Use ADORE-LA for Drunkard's Path + Scraps



Finished quilt measures: 50" x 60"

Pattern Level: Experienced Intermediate

"I know the ropes and would like to test my skills!"

ROBERT KAUFMAN
F A B R I C S

Fabric and Supplies Needed

Fabric amounts based on yardage that is 40" wide.

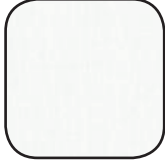
Color	Fabric	Name/SKU	Yardage	Color	Fabric	Name/SKU	Yardage
	A	K001-362 Kona Dusty Blue	1/2 yard		D	K001-1056 Kona Buttercup	1/2 yard
	B	K001-1223 Kona Medium Grey	1/2 yard		E	K001-493 Kona Limelight	1/4 yard
	C	K001-1483 Kona Salmon	1/2 yard		F	K001-1339 Kona Snow	3-1/2 yard
Copyright 2015, Robert Kaufman For individual use only - Not for resale				You will also need: 1/2 yards Kona Peach for Binding 4 yards Backing 2 yards of 90" wide Batting			

Notes Before You Begin

- Read through all of the instructions before beginning.
- All of the seam allowances are 1/4" unless otherwise noted.
- Press seam allowances open unless otherwise noted.
- Width of fabric (WOF) is equal to at least 42" wide.
- Remember to measure twice and cut once!

Printing Instructions

Print one copy of Template A and B at 100%.
 Optional: Trace the templates to template plastic.

Cutting Instructions

WOF = width of fabric
 Templates are on pages 5 & 6.

For use with Accuquilt 7" Drunkard's Path Die or Templates A & B provided.

Fabric A (Dusty Blue)

- Cut four squares 6" x 6".
- Cut four pieces using template A.

Fabric B (Medium Grey)

- Cut four squares 6" x 6".
- Cut four pieces using template A.

Fabric C (Salmon)

- Cut four squares 6" x 6".
- Cut four pieces using template A.

Fabric D (Buttercup)

- Cut four squares 6" x 6".
- Cut four pieces using template A.

Fabric E (Limelight)

- Cut two squares 6" x 6".
- Cut two pieces using template A.

Fabric F (Snow)

- Cut eighteen pieces using template B.
- Cut one strip 60 1/2" x 6" (strip on the right)
- Cut one strip 60 1/2" x 22 1/2" (strip on the left)
- Cut one strip 22 1/2" x 6"
- Cut two strips 11 1/2" x 6"

Backing Fabric

- Cut two pieces 2 yards x WOF.

Binding Fabric (Peach)

- Cut six strips 2 1/2" x WOF.

Batting

- Cut one piece 60" x 80".

Assembly Instructions



(fig. 1)

1. Sew Kona Snow Template B pieces to all Template A pieces. Press seam toward color A.

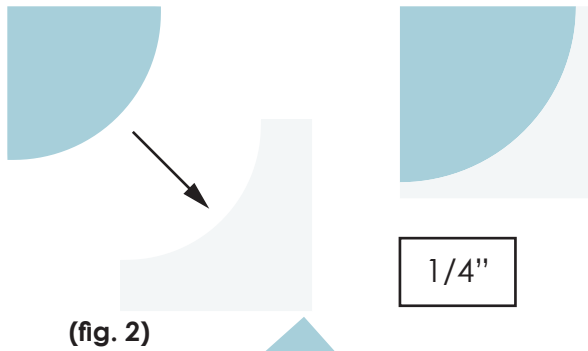

2. Trim blocks AB to 6" x 6" with a quarter inch seam allowance on piece B. **(fig2)**

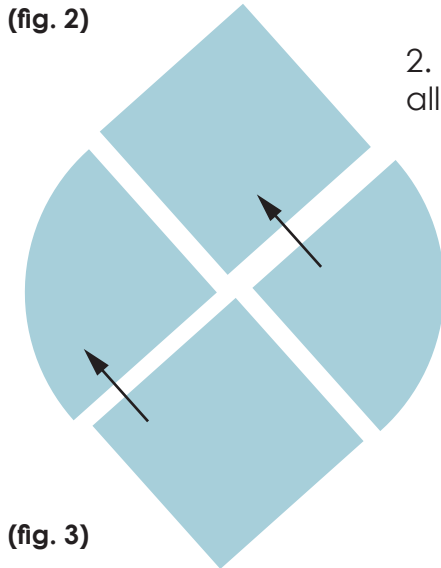

3. Sew one Dusty Blue Kona 6" x 6" square to the left of Dusty Blue Kona block AB with Dusty Blue sides matching and Snow Kona on the right. Sew remaining Dusty Blue Kona 6" x 6" square to the right of Dusty Blue Kona block AB with Dusty Blue sides matching and Snow Kona on the left. Press seam toward the square. **(fig 3)**

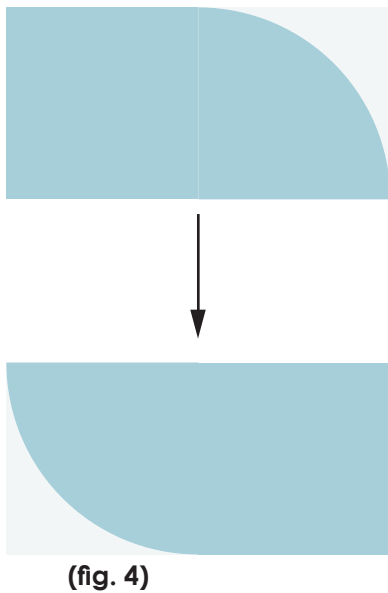

4. Sew the two blocks together created in step 3 with the first piece above the second, matching seams. **(fig 4)**

5. Repeat steps 3 and 4 to create a total of 2 Dusty Blue Kona Petals, 2 Medium Grey Kona Petals, 2 Salmon Kona Petals, 2 Buttercup Kona Petals, and 1 Limelight Kona Petal.

6. Sew one strip of Petals together in the following order from top to bottom, noting petal orientation in quilt assembly diagram: Medium Grey Kona to Buttercup Kona to Limelight Kona to Dusty Blue Kona to Salmon Kona.
7. Sew the second strip of Petals together along with the two 11 1/2" x 6" strips of Snow Kona in the following order from top to bottom, noting petal orientation in quilt assembly diagram: Snow Kona to Dusty Blue Kona to Salmon Kona to Medium Grey Kona to Buttercup Kona to Snow Kona.
8. Sew together the two columns made in Steps 6 and 7 with the strip from Step 6 on the right and the strip from Step 7 on the left.
9. Sew 22 1/2" x 6" Snow Kona to the top of the two columns.
10. Sew 60 1/2" x 6" Snow Kona strip to the right of the Petals.
11. Sew 60 1/2" x 22 1/2" Snow Kona strip to the left of the Petals.
12. Baste, quilt and bind.

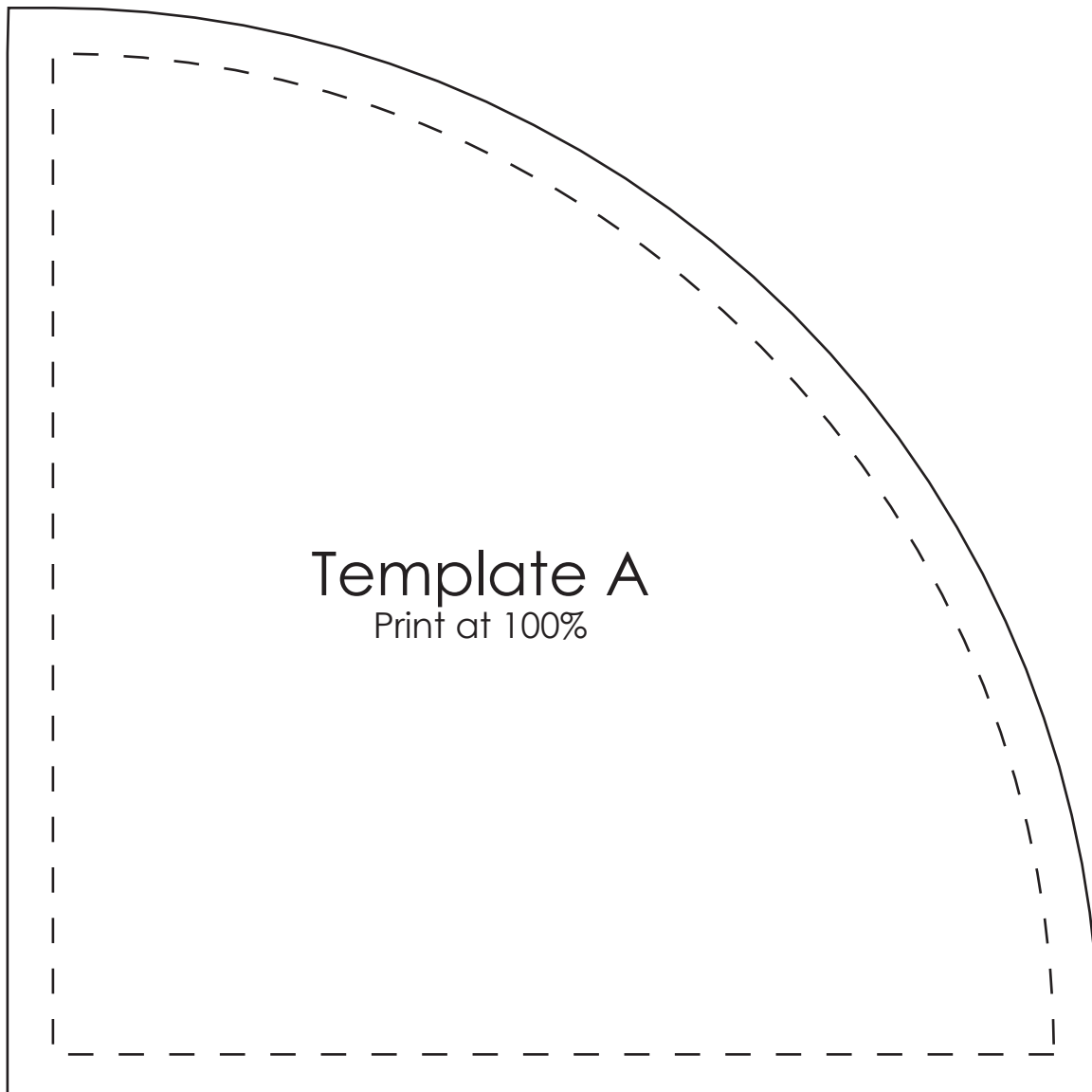

Template B

Print at 100%

"Below, use the drawing to better understand how to cut the fabric. I left a 0.5 cm margin on the inner edges for my model, which is where I sewed to close the sheet."

