



Cookie Plate Crumb Catcher

15" (wide) | Includes two finishing options

Designed by Julie Cefalu
Exclusively for *The Crafty Quilter Blog*

www.thecraftyquilter.com



Supplies

- 1/8 yard - Brown (A/B)
- 1/8 yard - Gold (C/D)
- 1/8 yard - Cream (E/H)
- 1/4 yard - Medium blue (F)
- 1/4 yard - Light blue (G)
- 1/4 yard - Binding (optional)
- 1 fat quarter - Backing
- 18" square - Batting (or fusible fleece)

Cutting Chart

Color	Qty	Piece	Cut size
	4	A	3" square
	2	B	3 1/2" square
	4	C	3" square
	2	D	3 1/2" square
	8	E	3" square
	4	F	5 1/2" square
	1	G	9" sq.

Binding an octagon shape can be a little tricky, so I'm including two options for finishing this project.

- Option 1 uses traditional binding techniques.
- Option 2 uses self-binding, otherwise known as the "pillowcase" method.

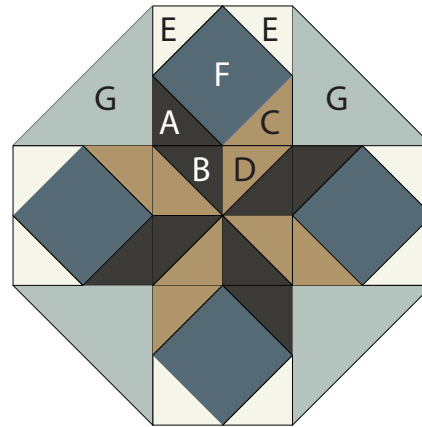

- Please read ALL instructions before starting.
- All seams 1/4" seam allowance
- RST = right sides together
- HST = half-square triangle
- SIAS = square in a square



Square in a square (SIAS) units

1. Draw a diagonal line on the wrong side of each 3" A/C/E square.
2. Place a marked A square and E square RST on opposite corners of the 5 1/2" F square. Stitch on the marked line.
3. Trim seam allowance and press towards the corners.
4. Repeat steps 2-3 using C and E squares for the remaining two corners to create the SIAS.
5. Make four SIAS units. They should measure 5 1/2" square.

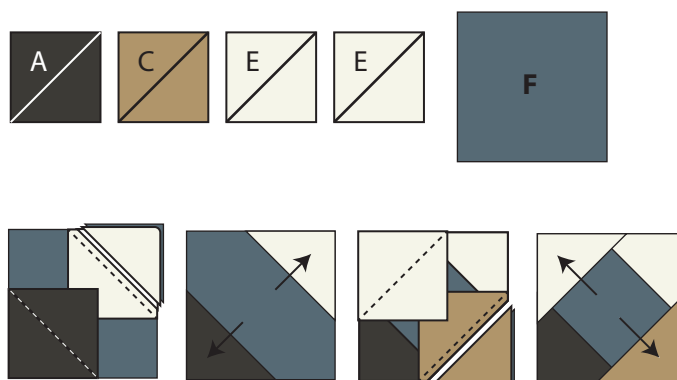

Pinwheel unit

6. Draw a diagonal line on the wrong side of both 3 1/2" D squares.
7. Place a marked D square RST with a 3 1/2" B square. Stitch 1/4" away on each side of the marked line.
8. Cut apart on the marked line and press towards the darker side.
9. Trim to size: 3" square. Make 4 HST units.
10. Arrange HST units to form a pinwheel, making sure the light and dark sides are oriented exactly as shown.
11. Sew the HST's into pairs. Press to the dark.
12. Sew the pairs together to create the pinwheel unit. Press open or "spin" the seams. It should measure 5 1/2" square.

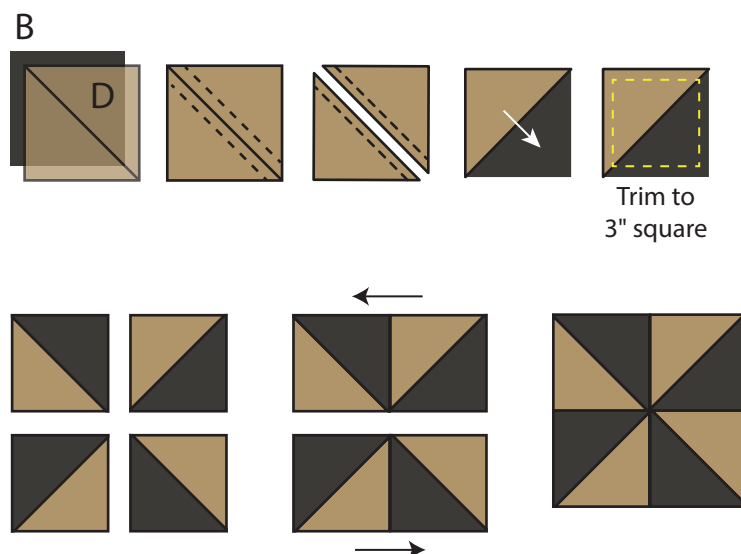

Assembly

9. Arrange the SIAS units, pinwheel unit and corner triangles (G) as shown.
10. Sew the units into rows. Press seams as indicated.
11. Sew the rows together, nesting seams. Press seams as indicated.
12. Final block should measure 15 1/2" wide.

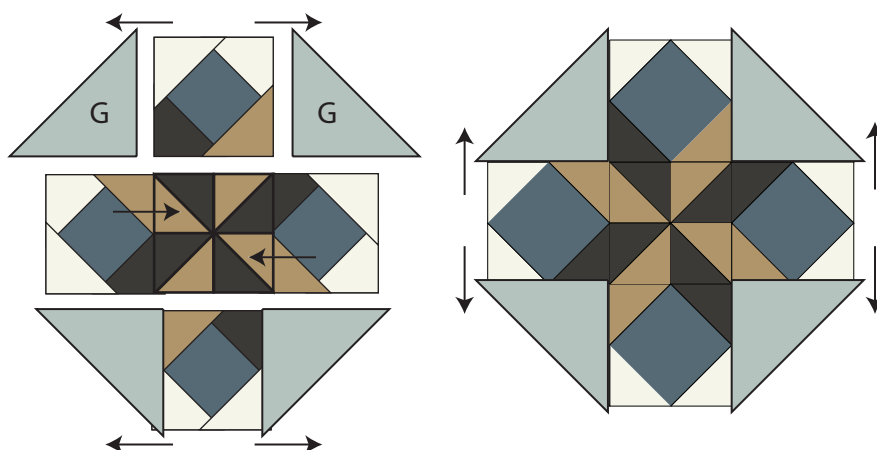



Trim the corner triangles as follows.

13. Place pieced top wrong side up.
14. Trim the angled edges (corner triangles) even with the seam allowance. It will extend a bit beyond the seam.



View from the right side

OPTION 1 (Traditional binding)

Note: Steps 1-5 are not pictured.

1. Baste the top, batting and backing fabric together.
2. Quilt as desired. I used a walking foot and stitched in the ditch.
3. Trim the excess batting and backing on all eight sides.
4. Cut the binding fabric into (2) 2 1/2" x WOF strips and join with a diagonal seam.
5. Use your favorite method to apply the binding, using the following steps for each corner:
 - At the corner, fold the binding up at a 135° angle so it forms a straight line with the new side. Then fold it down so the binding fold is horizontal and the raw edges are even. The fold will seem smaller than a typical 90° corner.
 - Continue stitching from the fold to the next corner and repeat. This will create a small miter on the front and back of each corner. Finish by hand or machine.





OPTION 2 (Self-binding)

Note: Steps 1-4 are not pictured.

1. Baste the top and batting only. I used fusible fleece for this option, but either is fine.
2. Quilt as desired. I used a walking foot and stitched in the ditch.
3. Trim the excess batting (if using).
4. Trim the backing fabric to the exact size as the quilted top.
5. Place the quilted top and backing RIGHT SIDES TOGETHER. Pin or use clips to secure the raw edges.
6. Stitch around the edges with 1/4" seam allowance, LEAVING 3" OPEN ON ONE SIDE for turning.
7. Clip the excess seam allowance at the corners to reduce bulk and turn right side out.
8. Push out the corners and press, turning the opening seam allowance in so it's straight and flat.
9. Top stitch close to the edges. This will close up the turning edge at the same time.

For more details and photos about this project, check out my blog and search for Cookie Plate Crumb Catcher.

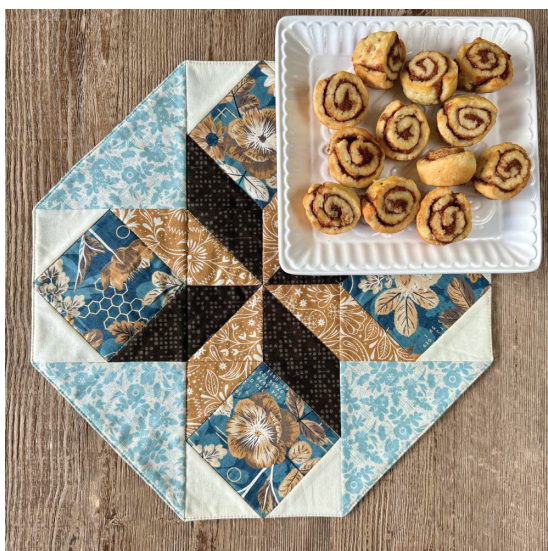

Now that I've made this with both binding options, I prefer the look of this one, Option 2. It looks more like a placemat and less like a quilt. Plus, it's a lot quicker and easier to finish!

Cookie Plate Crumb Catcher



Finished size: 15" diameter

All seam allowances are 1/4"

Supplies:

Fabric A (red):	1/8 yard	Backing:	1 fat quarter
Fabric B (red/white dot):	1/8 yard	Binding:	1/4 yard
Fabric C (green floral):	1/4 yard	Batting:	Scrap – 18” square
Fabric D (ivory print):	1/8 yard		
Fabric E (red/white check):	1 fat quarter		

Cutting Instructions:

- Fabric A: Cut (2) 3 1/2” squares; cut (4) 3” squares
- Fabric B: Cut (2) 3 1/2” squares; cut (4) 3” squares
- Fabric C: Cut (4) 5 1/2” squares
- Fabric D: Cut (8) 3” squares
- Fabric E: Cut (1) 9” square, subcut on both diagonals to make 4 setting triangles

General Information: You will be making (1) pinwheel unit and (4) square-in-a-square units that all measure 5 1/2” (unfinished). The layout is as show below:

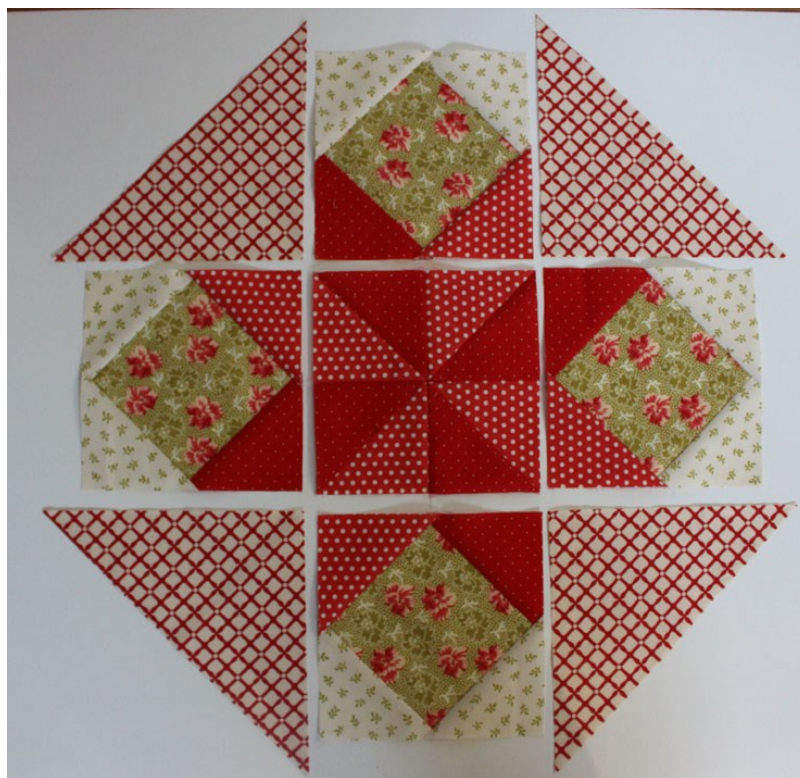

Piecing Instructions

Make pinwheel block:

- Draw a diagonal line on wrong side of Fabric A $3\frac{1}{2}$ " squares.
- Layer Fabric A and B $3\frac{1}{2}$ " squares, right sides together and sew $\frac{1}{4}$ " from each side of diagonal line. Cut on drawn line and press towards dark fabric.
- Trim to 3" squares.

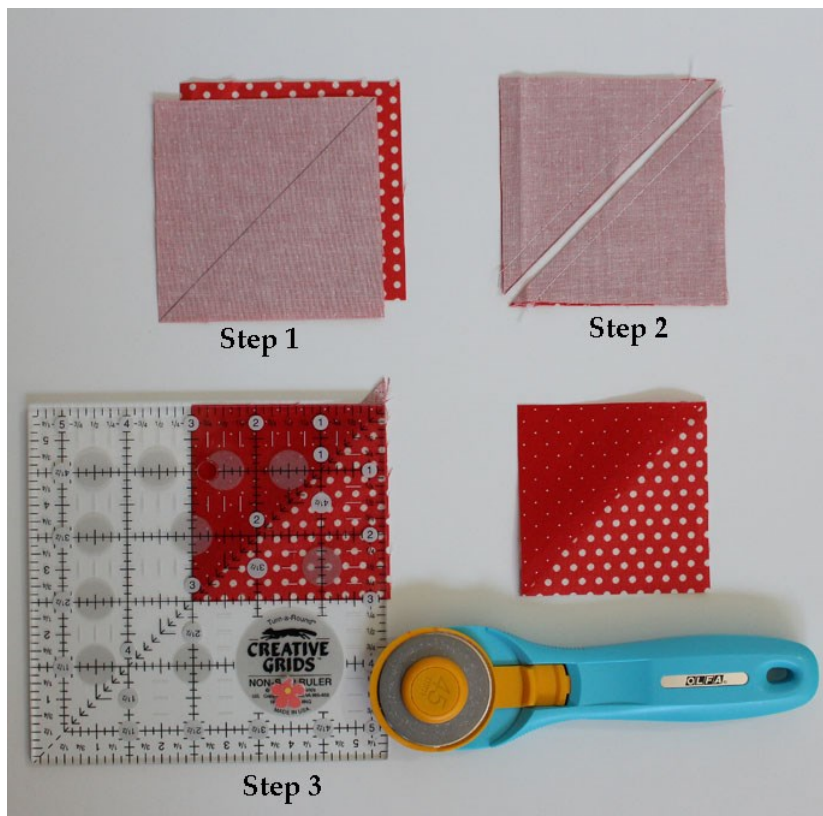

- Lay out triangle squares to form a pinwheel. Stitch squares together into pairs and then stitch pairs together to form (1) $5\frac{1}{2}$ " unfinished pinwheel block.

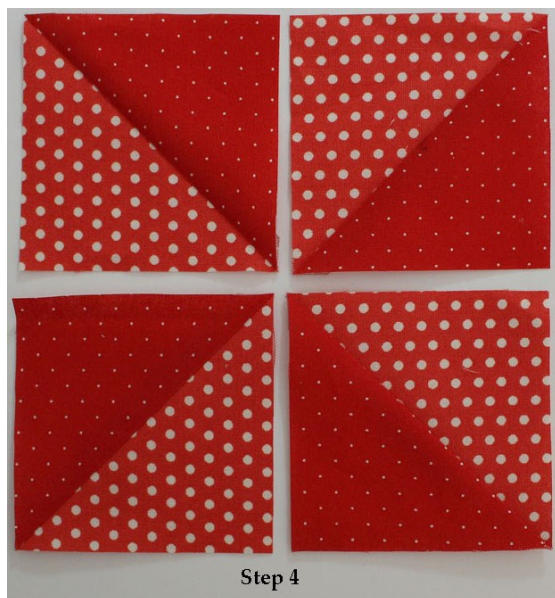

Make square in a square units:

- Draw a diagonal line on Fabric A, B, and D 3" squares.
- Using the stitch & flip method, sew (1) A, (1) B and (2) D squares to the corners of the 5 1/2" Fabric C square.



- Make sure that the Fabric A & B squares are in the correct position so that they match the same color when joined to the pinwheel block.



Repeat to make 4 units that measure 5 1/2" square.

Optional: Use the perfect square-in-a-square method to make these units as shown in my technique [here](#).



Assemble Quilt:

- Place the pinwheel unit, the 4 square-in-a-square units and the setting triangles into rows as shown at right.
- Stitch the rows together.
- Press the top and bottom row seams toward the setting triangles and press the center row seams toward the middle.
- Join rows together, matching seam intersections.

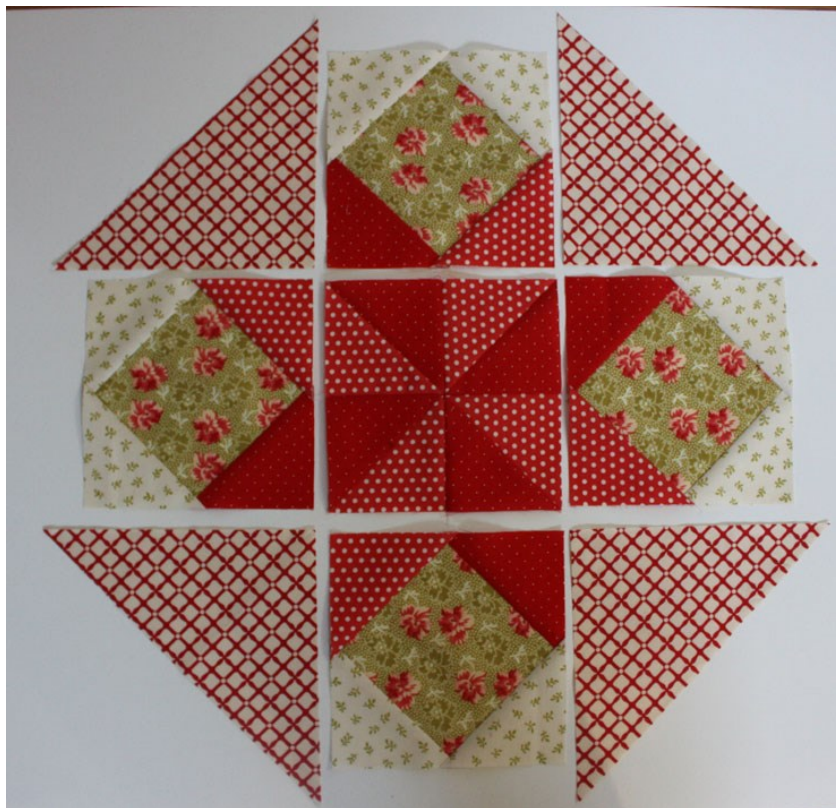

Since the setting triangles are oversized, you need to trim the edges.

First trim the points even with the side edges as shown at left.

Then trim the long edges even with the corner seams (below).



Layer backing, batting and top.
Baste. Quilt. Bind.

If needed, see my original post, [Cookie Plate Crumb Catcher](#), for binding instructions for the corners.

www.thecraftyquilter.com

The Mug Rug Crumb Catcher

This is a mini version of the original. It measures 8 1/2" wide.

No binding is necessary; just layer, stitch the perimeter, but leave an opening for turning. Topstitch close to edge and quilt if desired.

See [The Crafty Quilter](#) for more details.



Cutting Instructions for
the Mug Rug Crumb
Catcher:

Assemble the same way
as the Cookie Plate
Crumb Catcher.

