

GO! New York Reflections Throw Quilt

Finished Size: 44" x 44"



Designed for AccuQuilt by Suzy Webster of Webster Quilts



Dies Needed:

GO! New York Beauty-9" Finished (55932)

Additional Dies (optional)

- GO! Strip Cutter-1-1/2" (1" Finished) (55024)
- GO! Strip Cutter-2-1/2" (2" Finished) (55017 or 55014)
- GO! Strip Cutter-3-1/2" (3" Finished) (55032)

Fabric Requirements:

Fabric Color	Total Yardage
Gold	1 ¼ yards
Purple	¾ yard
Black	2 yards
Turquoise	1 ⅛ yards
Binding	½ yard
Backing	2 yards

Cutting Directions:

Fabric Color	Die	Number of Shapes to Cut
Gold	GO! New York Beauty-9" Finished (55932)	Cut 16 - 10" squares. Lay on top of the die covering A and B Pieces. Subcut 16 A and 16 B pieces.
Purple	GO! New York Beauty-9" Finished (55932)	Cut 16 – 5-1/2" squares. Subcut into 16 D pieces.
Purple	GO! Strip Cutter-1-1/2" (1" Finished) (55024)	Cut 4 – 1-1/2" x WOF strips.
Black	GO! New York Beauty-9" Finished (55932)	Cut 2 – 4-1/4" strips. Subcut into 32 E pieces. 16 will need to be right side up and 16 will need to be upside down.
Black	GO! New York Beauty-9" Finished (55932)	Cut 4 – 4-1/4" strips. Subcut into 64 F pieces.
Black	GO! New York Beauty-9" Finished (55932)	Cut 16 - 10" squares. Subcut into 16 C pieces.
Turquoise	GO! New York Beauty-9" Finished (55932)	Cut 4 – 4-1/4" strips. Subcut into 80 G pieces.
Turquoise	GO! Strip Cutter-3-1/2" (3" Finished) (55032)	Cut 5 – 3-1/2" x WOF strips
Binding	GO! Strip Cutter-2-1/2" (2" Finished) (55017 or 55014)	Cut 5 – 2-1/2" x WOF strips

Sewing Directions:

Press all seams open and use ¼" seams, unless otherwise indicated.

1. Sew 5 blue shape G and four black shape F together. Press seams open. Sew 16 sets.
2. Sew 1 black shape E facing left and 1 black shape E facing right to the ends of GF unit as shown. Press seams open.
3. With right sides together and matching notches, align the raw edge of purple shape D's small curved edge to the raw edge of gold shape A's curved edge. Add pins and ease fabric as needed, to ensure a smooth seam. Sew shape D and A together using a consistent ¼" seam allowance. Press seams towards shape A. Make 16.
4. Using the same process as step 3, with right sides together and matching notches, align EFG unit to AD unit as shown. Add pins and ease fabric as needed to ensure a smooth seam. Sew together using a consistent ¼" seam allowance. Press seam towards AD unit.
5. Using the same process as previous steps, with right sides together and matching notches, align shape B to EFG unit as shown. Add pins and ease fabric as needed to ensure a smooth seam. Sew together using a consistent ¼" seam allowance. Press seam towards shape B.
6. Using the same process as previous steps, with right sides together and matching notches, align shape C to shape B as shown. Add pins and ease fabric as needed

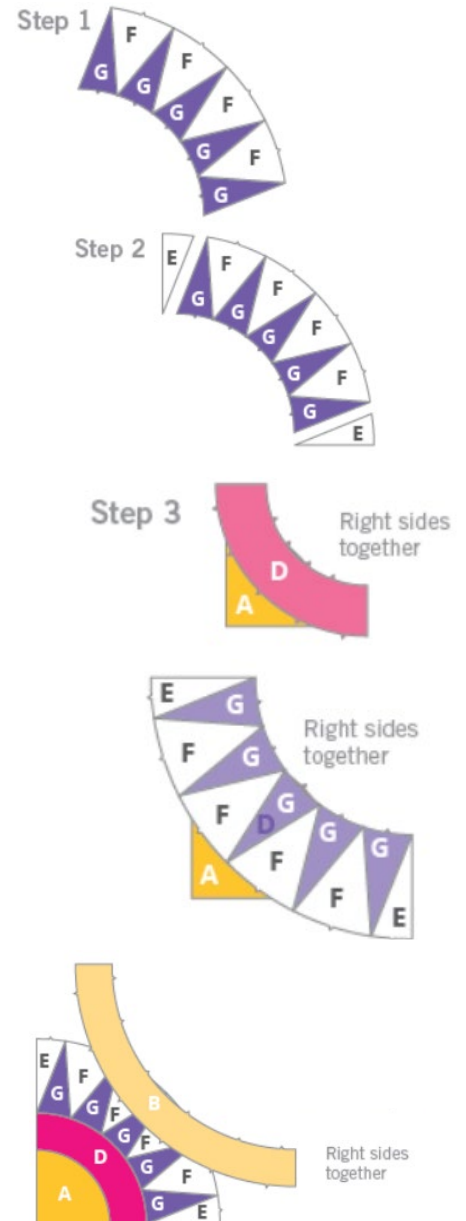

to ensure a smooth seam. Sew together using a consistent $\frac{1}{4}$ " seam allowance. Press seam towards shape C.

7. The block should measure $9\frac{1}{2}$ " x $9\frac{1}{2}$ " inches. You should have 16 blocks.

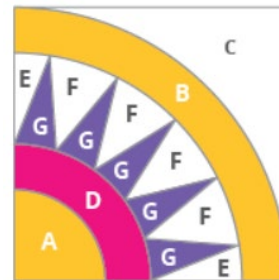
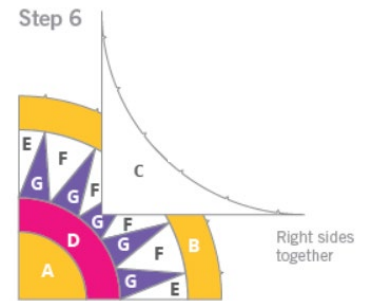

Assemble the Quilt Top

1. Lay out blocks in rows as shown in the quilt diagram. Sew blocks together into rows. Press seams open.
2. Sew rows together. Press seams open.
3. Sew left and right purple border on. Start by measuring the height of the quilt. Then cut two of the strips to the same length. Sew to the left and right sides.
4. Sew top and bottom purple border on. Measure the width of the quilt. Then cut the remaining strips to the same length. Sew to the top and bottom of the quilt.
5. Repeat the above process to sew on turquoise 3 ½" borders.

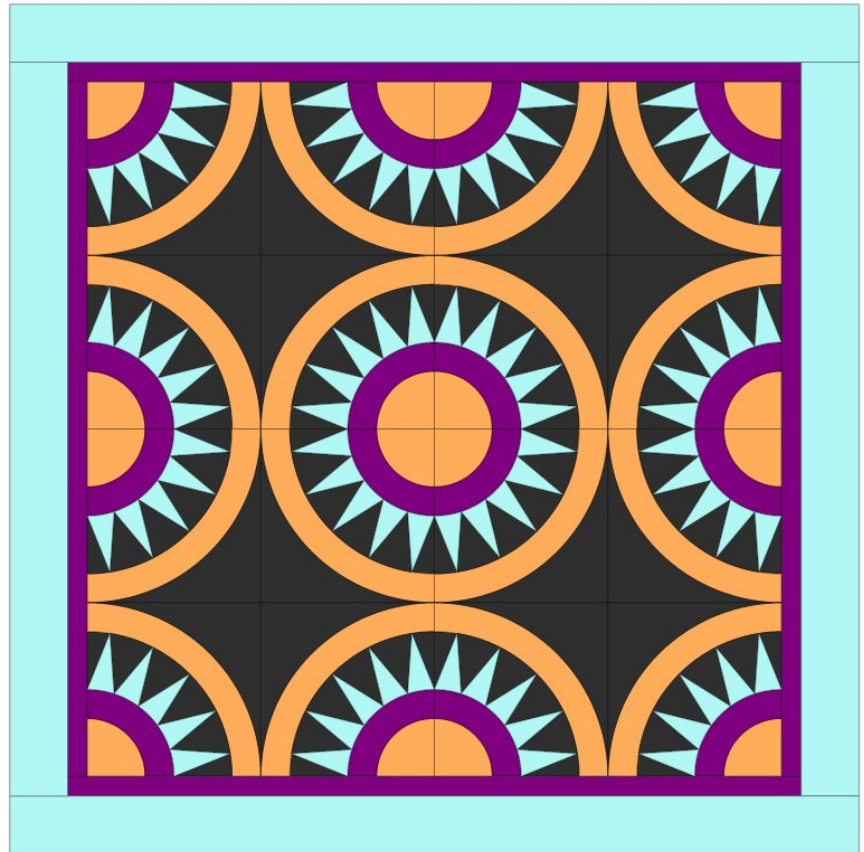

Quilting and Finishing

1. Layer batting between quilt top and backing.
2. Pin or baste layers together.
3. Quilt as desired.
4. Add binding, mitering corners.